



1800 Series Flush Doors

18 GAUGE STOCK REVERSIBLE SEAMLESS POLYSTYRENE FLUSH DOORS

- Includes closer reinforcement, fire label WHI 3HR Positive Pressure (S) Smoke label
- STC rating 26, R value 5.24, U value 0.31 and Other locations and sizes are available
- Choice of 3 Standard Lock Reinforcements (Cylindrical, FED 86 Edge, Blank PB Reinforced)

DOOR MANUFACTURERS CHART (ALL DOORS ARE NON-HANDED)

CE	Ceco Location	DE	Dean Steel Location
CU	Curries Location	REP	Republic Location, for NEW REP locations, use DE
ME	Mesker Location, use DE Location	PIO	Pioneer Location, available at PA warehouse only

ITEM#	SIZE	PREP	GAUGE
1801	2068	C	18
1802		MB	
1805		BR	
1835	2070	C	18
1836		MB	
1838		BR	
1851	2080	C	18
1857		BR	
1810	2468	C	18
1811		MB	
1875	2470	C	18
1876		MB	
1807	2668	C	18
1808		MB	
1809		BR	
1891	2670	C	18
1892		MB	
1893		BR	
1828	2680	C	18
1829		MB	
1825	2868	C	18
1826		MB	
1894	2870	C	18
1895		MB	
1869	21068	C	18
1870		MB	
1871		BR	
1897	21070	C	18
1898		MB	
1899		BR	
1886	21080	C	18
1889		BR	

* NEW ITEM

ITEM#	SIZE	PREP	GAUGE
1813	3068	C	18
*1815CA		C/DL, 4" CTC, CA-ADA	
1815		C/DL 4" CTC	
1816		C/DL, ADA 7-11/16" CTC	
1817		C/DL, 5-1/2" CTC	
*1817CA		C/DL 5-1/2", CA-ADA	
*N1817CA		C/DL 5-1/2", NEW CA-ADA	
1818		MB	
1824		BR	
1413		T	
1839	3070	C/DL, ADA 7-11/16" CTC	18
1840		C	
*1841CA		C/DL 5-1/2", CA-ADA	
*N1841CA		C/DL 5-1/2", NEW CA-ADA	
1841		C/DL, 5-1/2" CTC	
1843		C/DL, 4" CTC	
*1843CA		C/DL, 4" CTC, CA-ADA	
1844		MB	
1847		BR	
1440		T	
1848	3072	C	18
1845		MB	
1846		BR	
1863	3080	C	18
1862		MB	
1864		BR	
1819	3468	C	18
1820		MB	
1806		BR	
1821	3470	C	18
1814		MB	
1830	3668	C	18
1831		MB	
1832		BR	
1849	3670	C	18
1850		MB	
1852		BR	

CONTINUED ON NEXT PAGE

SEE PAGE 11 OF CATALOG FOR CA-ADA DETAILS



1800 Series Flush Doors

18 GAUGE STOCK REVERSIBLE SEAMLESS POLYSTYRENE FLUSH DOORS

- Includes closer reinforcement, fire label WHI 3HR Positive Pressure **S** Smoke label
- STC rating 26, R value 5.24, U value 0.31, Other locations and sizes are available
- Choice of 3 Standard Lock Reinforcements (Cylindrical, FED 86 Edge, Blank PB Reinforced)

DOOR MANUFACTURERS CHART (ALL DOORS ARE NON-HANDED)

CE	Ceco Location	DE	Dean Steel Location
CU	Curries Location	REP	Republic Location, for NEW REP locations, use DE
ME	Mesker Location, use DE Location	PIO	Pioneer Location, available at PA warehouse only (non handed)

CONTINUATION			
ITEM#	SIZE	PREP	GAUGE
1860	3680	C	18
1861		MB	
1834	3868	C	18
1837		MB	
1842		BR	
1853	3870	C	18
1858		MB	
1856		BR	
1872	4068	C	18
1873		MB	
1874		BR	
1854	4070	C	18
1855		MB	
1859		BR	
1865	4080	C	18
1866		MB	
1868		BR	
GALVANIZED			
1880	3068	C	18
1881		MB	
1882		BR	
1884	3070	C	18
1887		MB	
1890		BR	
1885		T	
*G1863	3080	C	18
*G1862		MB	
*G1864		BR	
**1883	3480	C	18

ITEM#	SIZE	PREP	GAUGE
GALVANIZED			
*G1849	3670	C	18
*G1850		MB	
*G1853	3870	C	18
*G1858		MB	
*G1856		BR	
*G1854	4070	MB	18
*G1859		BR	
*G1865	4080	C	18
*G1866		MB	
*G1868		BR	

GALVANIZED CURRIES LOCATION DOORS			
CUG1824	3068	BR	18
CUG1840	3070	C	18
CUG1844		MB	
CUG1847		BR	

GALVANIZED CECO LOCATION DOORS			
CEG1813	3068	C	18
CEG1818		MB	
CEG1824		BR	
CEG1840	3070	C	18
CEG1844		MB	
CEG1847		BR	

* **NEW ITEM** Available in Houston, TX warehouse only
 ** **NEW ITEM** Available in PA warehouse only

CONTINUED ON NEXT PAGE



1800 Series Flush Doors

18 GAUGE STOCK REVERSIBLE SEAMLESS POLYSTYRENE FLUSH DOORS

- Includes closer reinforcement, fire label WHI 3HR Positive Pressure **(S)** Smoke label
- STC rating 26, R value 5.24, U value 0.31, Other locations and sizes are available
- Choice of 3 Standard Lock Reinforcements (Cylindrical, FED 86 Edge, Blank PB Reinforced)

DOOR MANUFACTURERS CHART (ALL DOORS ARE NON-HANDED)

CE	Ceco Location	DE	Dean Steel Location
CU	Curries Location	REP	Republic Location, for NEW REP locations, use DE
ME	Mesker Location, use DE Location	PIO	Pioneer Location, available at PA warehouse only

CONTINUATION			
ITEM#	SIZE	PREP	GAUGE
CECO LOCATION DOORS			
CE1813	3068	C	18
CE1818		MB	
CE1840	3070	C	18
CE1844		MB	
CE1847		BR	
CURRIES LOCATION DOORS			
CU1813	3068	C	18
CU1818		MB	
CU1824		BR	
CU1840	3070	C	18
CU1844		MB	
CU1847		BR	
CU1854	4070	C	
CU1855		MB	

ITEM#	SIZE	PREP	GAUGE
DEAN STEEL, MESKER AND (NEW) REPUBLIC LOCATION DOORS			
DE1813	3068	C	18
DE1818		MB	
DE1824		BR	
DE1840	3070	C	18
DE1844		MB	
DE1847		BR	
PIONEER LOCATION DOORS			
**PIO1813	3068	C	18
**PIO1818		MB	
**PIO1840	3070	C	18
**PIO1844		MB	
(OLD) REPUBLIC LOCATION DOORS			
***REP1813	3068	C	18
***REP1818		MB	
***REP1824		BR	
REP1840	3070	C	18
REP1844		MB	
REP1847		BR	
***Use 1813, 1818, 1824 for REP1813, REP1818 & REP1824 respectively. ** Available in PA warehouse only			



1800 Series Seamless Doors with Cutouts

18 GAUGE STOCK REVERSIBLE SEAMLESS POLYSTYRENE DOORS WITH CUTOUTS

- includes closer reinforcement, appropriate WHI fire label Positive Pressure,  Smoke label
- STC rating 26, R value 5.24, U value 0.31
- Non-Handed
- Other locations and sizes are available

ITEM#	SIZE	DESCRIPTION	LOCK	CUT OUT SIZE	GAUGE
1813V	3068	Vision Lite	C	12 x 12	18
1818V			MB		
1840V	3070		C		
1844V			MB		
1813NL	3068	Narrow Lite	C	7 x 22	18
1813N				5 x 35	
1840NL	3070			7 x 22	
1840N				5 x 35	
1813HG	3068	Half Glass	C	24 x 30	18
1840HG	3070			24 x 32	
1840FG	3070	Full Glass	C	24 x 60	18
1844FG			MB		
1813L1-1212	3068	Louver	C	12 x 12	18
1818L1-1212			MB		
1840L1-1212	3070		C		
1844L1-1212			MB		
1813L1-1812	3068	C	18 x 12	18	
1818L1-1812		MB			
1840L1-1812	3070	C			
1844L1-1812		MB			
1813L1-2412	3068	C	24 x 12	18	
1818L1-2412		MB			
1840L1-2412	3070	C			
1844L1-2412		MB			



V1212

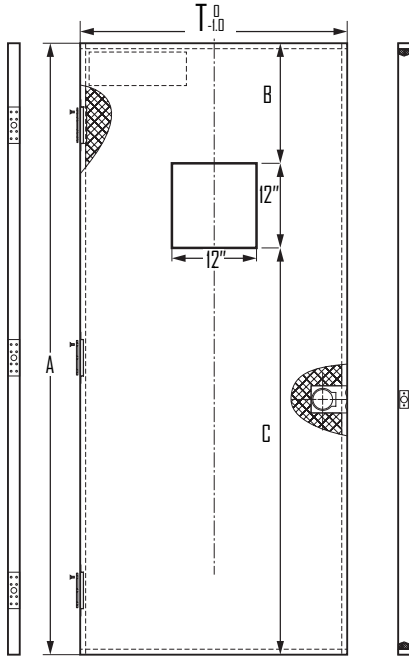

DOOR SIZE	A	B	C
6'8"	79.125"	11.0"	56.125"
7'0"	83.125"	15.0"	
8'0"	95.125"	27.0"	

NL722

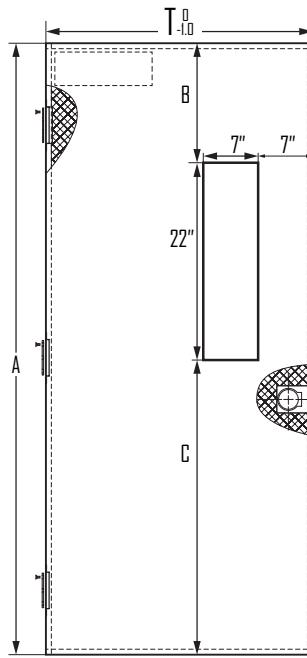

DOOR SIZE	A	B	C
6'8"	79.125"	11.0"	46.125"
7'0"	83.125"	15.0"	
8'0"	95.125"	27.0"	

N535

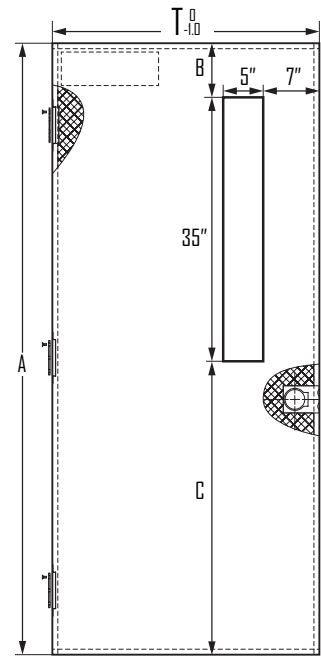

DOOR SIZE	A	B	C
6'8"	79.125"	2.0"	42.125"
7'0"	83.125"	6.0"	
8'0"	95.125"	6.0"	

HG2430 / HG2432

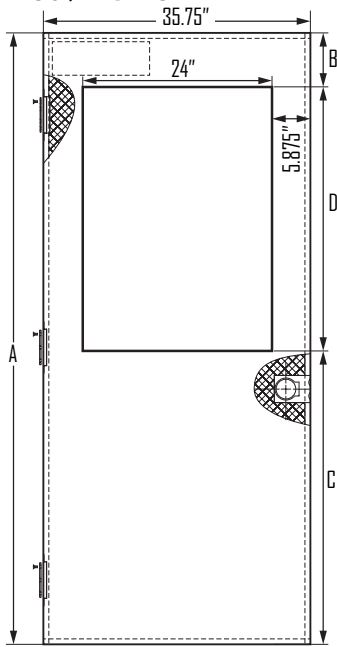

DOOR SIZE	A	B	C	D
6'8"	79.125"	7.0"	42.125"	30.0"
7'0"	83.125"	11.0"	42.125"	
8'0"	95.125"	11.0"	54.125"	
6'8"	79.125"	5.0"	42.125"	32.0"
7'0"	83.125"	9.0"	42.125"	
8'0"	95.125"	9.0"	54.125"	

FG2460

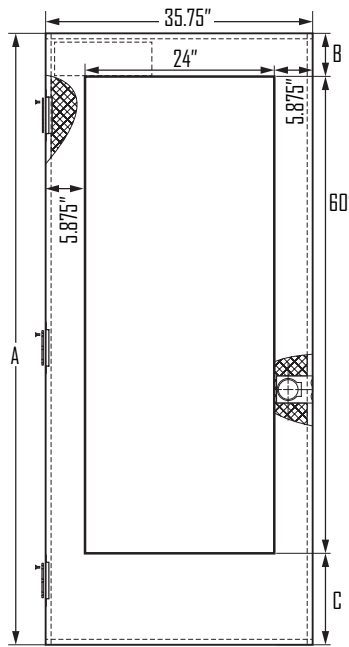

DOOR SIZE	A	B	C
6'8"	79.125"	4.0"	15.125"
7'0"	83.125"	8.0"	15.125"
8'0"	95.125"	7.0"	28.125"

L1212 / 1812 / 2412
LOUVER CUTOUT ONLY

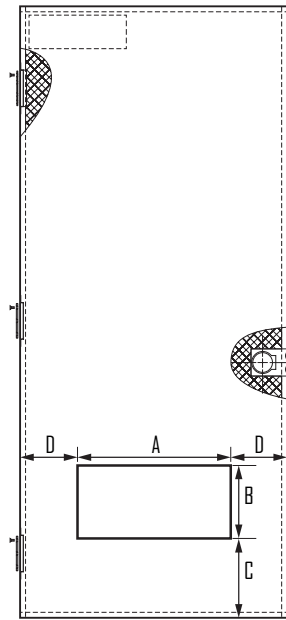

A	B	C	D
12"	12"	13"	EQUAL
18"	12"	13"	EQUAL
24"	12"	13"	EQUAL



1800 Series Polystyrene Flush Inactive Doors

18 GAUGE FOR ALL MAJOR MANUFACTURERS LOCATION

STOCK REVERSIBLE CORNER SEAM POLYSTYRENE FLUSH DOORS

- Includes closer reinforcement, fire label WHI 3HR, Positive Pressure **(S)** Smoke label
- Other locations and sizes are available

DOOR MANUFACTURERS CHART

CE	Ceco Location (non handed)
CU	Curries Location (non handed)
REP	Republic Location (non handed)

ALL INACTIVE DOORS ARE PREPARED FOR, AND PRICES INCLUDES:

- FLUSH BOLT GUIDES, TOP & BOTTOM
- LOOSE WRAP AROUND HANDED ASTRAGAL WITH FLUSHBOLT AND ASA PREP

* To be used for Steel Craft, Amweld and Republic locations

** To be used for Steel Craft, Amweld locations

INACTIVE DOORS			
HAND	ITEM#	SIZE	GAUGE
RH LH	1807 IA	2668	18
RH LH	1826 IA	2868	18
RH LH	CE1813 IA	3068	18
RH LH	1813 IA *		
RH LH	CU1813 IA		
RH LH	CE1840 IA	3070	18
RH LH	CU1840 IA		
RH LH	REP1840 IA		
RH LH	1840 IA **		
RH LH	1863 IA	3080	18
RH LH	1872 IA	4068	18

1800 & 1600 Series Polystyrene Flush Doors

PREPARED FOR FULL MORTISE CONTINUOUS HINGE APPLICATION

- Includes closer reinforcement, fire label WHI 3HR, Positive Pressure **(S)** Smoke label
- 15/32" undercut on door width to fit most major manufacturers continuous hinge

18 GAUGE			
ITEM#	SIZE	PREP	GAUGE
1813CHI	3068	C	18
1818CHI		MB	
1824CHI		BR	
1840CHI	3070	C	18
1847CHI		BR	
1863CHI	3080	C	18
1862CHI		MB	
1864CHI		BR	
**1874CHI	4068	BR	18

** **NEW ITEM** Available in PA warehouse only

16 GAUGE GALVANIZED			
ITEM#	SIZE	PREP	GAUGE
G1608CH	3070	MB	16
G1611CH		BR	
G1649CH	3670	C	16
G1650CH		MB	
G1654CH	4070	C	16
G1655CH		MB	
18 GAUGE GALVANIZED			
*G1813CHI	3068	C	18
*G1840CH	3070	C	18
*G1847CH		BR	
*G1863CH	3080	C	18
G1849CH	3670	C	18
G1850CH		MB	
G1854CH	4070	C	18
G1855CH		MB	

* **NEW ITEM** Available in Houston TX warehouse only



DOOR AND FRAME LOCATIONS

Standard Hardware Locations 4-1/2" Hinge

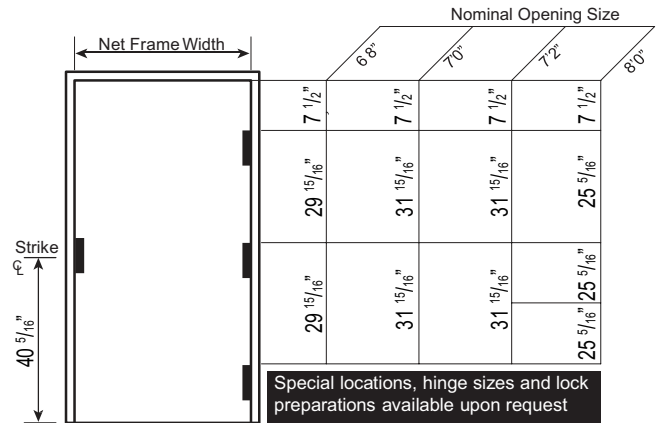
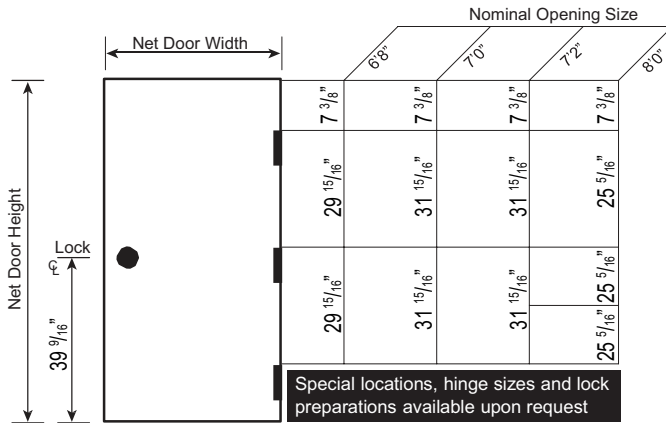

DOOR HANDING

SINGLE SWING DOORS

When door swings towards you and hinges are on the right side of the door - Door is R.H.R. / Frame is L.H.
 When door swings inside and hinges are on right side of the door - Door is R.H. / Frame is R.H.

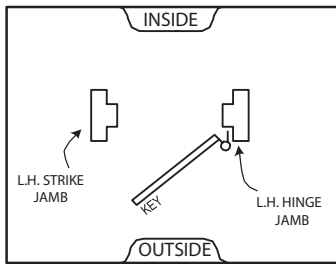

Right Hand Reverse Door (Swing Out) Left Hand Frame

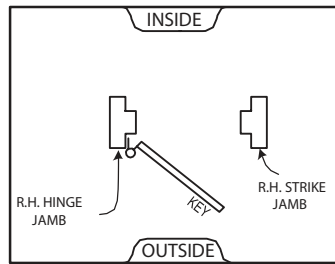

Left Hand Reverse Door (Swing Out) Right Hand Frame

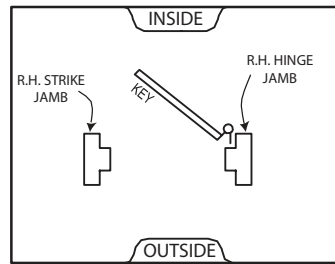

Right Hand Door (Swing In) Right Hand Frame

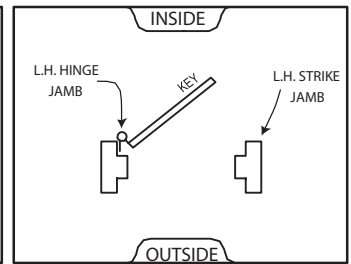

Left Hand Door (Swing In) Left Hand Frame

DOUBLE DOORS

When door leaf swings towards you and hinges are on the right side of active leaf - Door is R.H.R. Active / Frame is L.H. Active
 When door leaf swings inside and hinges are on right side of active leaf - Door is R.H. Active / Frame is R.H. Active

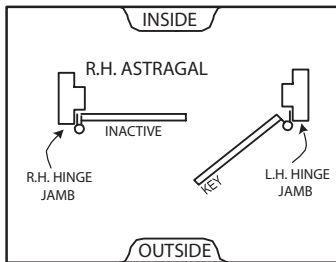

Pair of Doors - R.H.R. Active (Swing Out)
 Double Door Frame L.H. Active

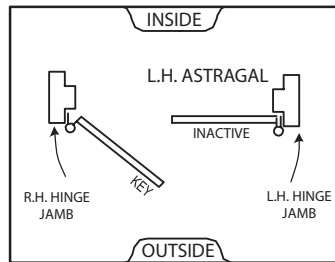

Pair of Doors - L.H.R. Active (Swing Out)
 Double Door Frame R.H. Active

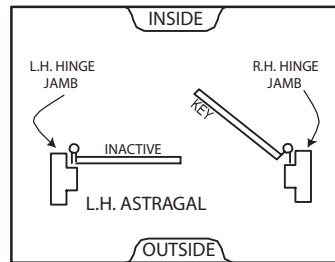

Pair of Doors - R.H. Active (Swing In)
 Double Door Frame R.H. Active

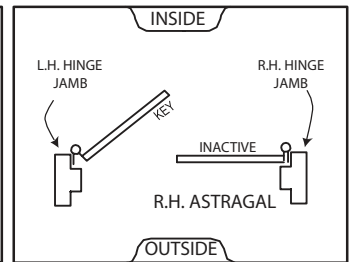

Pair of Doors - L.H. Active (Swing In)
 Double Door Frame L.H. Active